

Hladké trubky

HTEM Hladká trubka s hrdlem

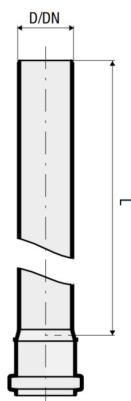
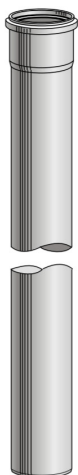

Kód	D	DN	L	kg/ks
VS0650001	32	30	150	0.055
VS0650003	32	30	250	0.071
VS0650005	32	30	500	0.126
VS0650007	32	30	1000	0.238
VS0650009	32	30	1500	0.322
VS0650011	32	30	2000	0.441
VS0650013	32	30	3000	0.655
VS0650021	40	40	150	0.069
VS0650023	40	40	250	0.091
VS0650025	40	40	500	0.160
VS0650027	40	40	1000	0.311
VS0650029	40	40	1500	0.457
VS0650031	40	40	2000	0.594
VS0650033	40	40	3000	0.895
VS0650041	50	50	150	0.089
VS0650043	50	50	250	0.123
VS0650045	50	50	500	0.213
VS0650047	50	50	1000	0.386
VS0650049	50	50	1500	0.581
VS0650051	50	50	2000	0.779
VS0650053	50	50	3000	1.137
VS0650061	75	70	150	0.186
VS0650063	75	70	250	0.269
VS0650065	75	70	500	0.471
VS0650067	75	70	1000	0.899
VS0650069	75	70	1500	1.283
VS0650071	75	70	2000	1.723
VS0650073	75	70	3000	2.400
VS0650081	90	90	150	0.283
VS0650083	90	90	250	0.403
VS0650085	90	90	500	0.698
VS0650087	90	90	1000	1.317
VS0650089	90	90	1500	1.855
VS0650091	90	90	2000	2.545
VS0650093	90	90	3000	3.060

HTEM Hladká trubka s hrdlem

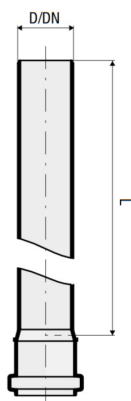
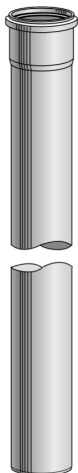

Kód	D	DN	L	kg/ks
VS0650101	110	100	150	0.386
VS0650103	110	100	250	0.552
VS0650105	110	100	500	0.966
VS0650107	110	100	1000	1.866
VS0650109	110	100	1500	2.619
VS0650111	110	100	2000	3.346
VS0650113	110	100	3000	5.162
VS0650121	125	125	150	0.610
VS0650123	125	125	250	0.734
VS0650125	125	125	500	1.272
VS0650127	125	125	1000	2.330
VS0650129	125	125	1500	3.286
VS0650131	125	125	2000	4.432
VS0650133	125	125	3000	6.545
VS0650141	160	150	150	1.103
VS0650143	160	150	250	1.227
VS0650145	160	150	500	2.101
VS0650147	160	150	1000	3.920
VS0650149	160	150	1500	5.665
VS0650151	160	150	2000	7.404
VS0650153	160	150	3000	10.700
VS0650167	200	200	1000	6.268
VS0650171	200	200	2000	11.568
VS0650173	200	200	3000	16.765
VS0650187	250	250	1000	9.805
VS0650193	250	250	3000	27.300



HTDM Hladká trubka s hrdlem

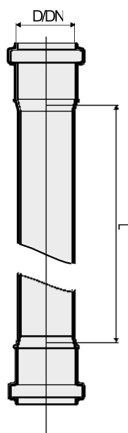
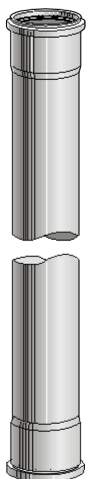

Kód	D	DN	L	kg/ks
VS0650205	32	30	500	0.127
VS0650207	32	30	1000	0.251
VS0650209	32	30	1500	0.354
VS0650211	32	30	2000	0.470
VS0650213	32	30	3000	0.707
VS0650225	40	40	500	0.160
VS0650227	40	40	1000	0.288
VS0650229	40	40	1500	0.415
VS0650231	40	40	2000	0.540
VS0650233	40	40	3000	0.800
VS0650245	50	50	500	0.200
VS0650247	50	50	1000	0.365
VS0650249	50	50	1500	0.500
VS0650251	50	50	2000	0.685
VS0650253	50	50	3000	1.040
VS0650265	75	70	500	0.465
VS0650267	75	70	1000	0.825
VS0650269	75	70	1500	1.210
VS0650271	75	70	2000	1.510
VS0650273	75	70	3000	2.295
VS0650285	90	90	500	0.695
VS0650287	90	90	1000	1.215
VS0650289	90	90	1500	1.810
VS0650291	90	90	2000	2.368
VS0650293	90	90	3000	3.480
VS0650305	110	100	500	0.945
VS0650307	110	100	1000	1.695
VS0650309	110	100	1500	2.455
VS0650311	110	100	2000	3.236
VS0650313	110	100	3000	4.706
VS0650325	125	125	500	1.160
VS0650327	125	125	1000	2.000
VS0650329	125	125	1500	2.880
VS0650331	125	125	2000	3.655
VS0650333	125	125	3000	5.495

Kolena

HTB koleno 15°

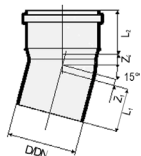

Kód	D	DN	Z ₁	L ₁	Z ₂	L ₂	kg/ks
VS0650401	32	30	3	48	6	44	0.021
VS0650411	40	40	4	47	8	44	0.035
VS0650421	50	50	4	48	8	46	0.045
VS0650431	75	70	7	53	11	52	0.110
VS0650441	90	90	8	56	14	56	0.168
VS0650451	110	100	9	61	16	59	0.250
VS0650461	125	125	10	66	17	64	0.357
VS0650471	160	150	12	45	22	73	0.652

HTB koleno 30°

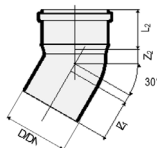

Kód	D	DN	Z ₁	L ₁	Z ₂	L ₂	kg/ks
VS0650403	32	30	5	48	8	44	0.021
VS0650413	40	40	7	47	10	44	0.037
VS0650423	50	50	8	48	12	46	0.048
VS0650433	75	70	12	53	17	52	0.120
VS0650443	90	90	14	56	20	56	0.183
VS0650453	110	100	17	61	23	59	0.271
VS0650463	125	125	18	66	26	64	0.392
VS0650473	160	150	23	75	33	73	0.723

HTB koleno 45°

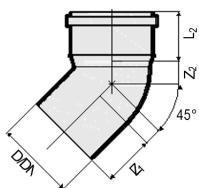
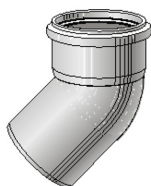

Kód	D	DN	Z ₁	L ₁	Z ₂	L ₂	kg/ks
VS0650405	32	30	8	45	10	44	0.023
VS0650415	40	40	10	47	14	44	0.040
VS0650425	50	50	11	48	17	46	0.053
VS0650435	75	70	18	53	22	52	0.128
VS0650445	90	90	21	56	26	56	0.198
VS0650455	110	100	25	61	31	59	0.273
VS0650465	125	125	28	66	35	64	0.428
VS0650475	160	150	35	75	45	73	0.765
VS0650485 *	200	200	63	180	86	170	3.500
VS0650495 *	250	250	57	210	88	203	5.090

* Svařovaný kus

HTB koleno 67°30'

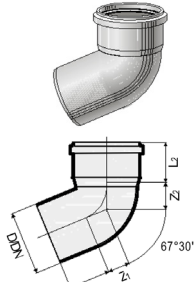

Kód	D	DN	Z ₁	L ₁	Z ₂	L ₂	kg/ks
VS0650407	32	30	10	51	15	47	0.023
VS0650417	40	40	15	47	19	44	0.042
VS0650427	50	50	18	48	22	46	0.056
VS0650437	75	70	28	53	33	52	0.140
VS0650447	90	90	33	56	38	56	0.224
VS0650457	110	100	40	61	45	59	0.333
VS0650467	125	125	43	66	51	64	0.478

HTB koleno 87°30'

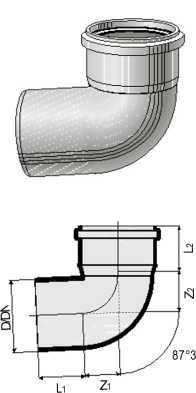

Kód	D	DN	Z ₁	L ₁	Z ₂	L ₂	kg/ks
VS0650409	32	30	20	45	19	44	0.024
VS0650419	40	40	22	47	25	44	0.045
VS0650429	50	50	26	48	30	46	0.060
VS0650439	75	70	40	53	43	52	0.153
VS0650449	90	90	46	56	51	56	0.241
VS0650459	110	100	57	61	61	59	0.367
VS0650469	125	125	62	66	70	64	0.530
VS0650479	160	150	78	75	89	73	1.000
VS0650489 *	200	200	148	180	172	170	3.720
VS0650499 *	250	250	122	210	163	203	5.040

* Svařovaný kus

Zaoblené koleno 87°30'

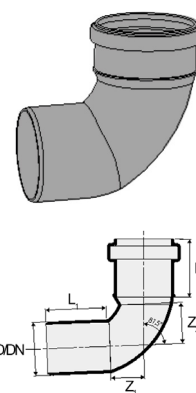

Kód	D	DN	Z ₁	L ₁	Z ₂	L ₂	kg/ks
VS0652901	40	40	25	45	30	43	0.057
VS0652902	50	50	31	46	37	45	0.079
VS0652903	75	70	48	56	54	52	0.176
VS0652904	90	90	57	56	64	56	0.253
VS0652905	110	100	69	64	78	59	0.413

T-kusy

HTEA T-kus 45°

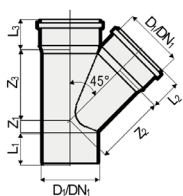
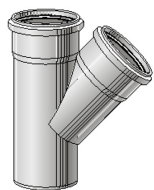

Kód	D ₁ /DN ₁	Z ₁	L ₁	Z ₂	L ₂	Z ₃	L ₃	kg/ks
VS0650501	32/32	7	50	44	44	44	44	0.041
VS0650507	40/40	10	46	49	44	49	44	0.075
VS0650513	50/50	12	50	61	46	61	46	0.100
VS0650519	75/70	19	53	96	52	96	52	0.265
VS0650525	90/90	21	56	110	56	110	56	0.385
VS0650531	110/100	25	61	135	59	135	59	0.645
VS0650537	125/125	28	66	152	65	152	65	0.940
VS0650543	160/150	36	75	198	73	199	73	1.780
VS0650669 *	200/200	46	145	273	135	273	135	5.880
VS0650685 *	250/250	21	170	336	160	336	160	10.480

* Svařovaný kus

HTEA T-kus 87°30' - bez náběhu

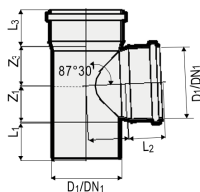
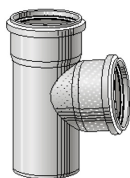

Kód	D ₁ /DN ₁	Z ₁	L ₁	Z ₂	L ₂	Z ₃	L ₃	kg/ks
VS0650505	32/32	21	45	17	52	17	52	0.037
VS0650511	40/40	19	46	24	44	28	44	0.065
VS0650517	50/50	28	50	29	46	29	46	0.085
VS0650523	75/70	39	53	46	52	46	52	0.215
VS0650529	90/90	48	56	52	56	52	56	0.310
VS0650535	110/100	56	61	65	59	65	59	0.500
VS0650541	125/125	65	66	71	65	71	65	0.730
VS0650547	160/150	80	75	94	73	97	73	1.340
VS0650671 *	200/200	100	145	137	135	137	135	4.900
VS0650687 *	250/250	130	170	165	160	165	160	8.580

* Svařovaný kus

HTEA T-kus 87°30' - s náběhem

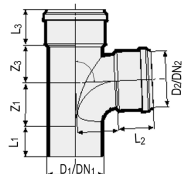
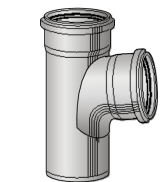

Kód	D ₁ /D ₂	DN ₁ /DN ₂	Z ₁	L ₁	Z ₂	L ₂	Z ₃	L ₃	kg/ks
VS0650694	90/90	90/90	57	56	64	56	47	59	0.415
VS0650695	110/75	110/70	48	81	54	52	58	59	0.503
VS0650696	110/90	100/90	57	72	64	56	58	59	0.539
VS0650693	110/110	100/100	69	64	78	66	58	59	1.070

HTEA T-kus 45° - redukovany

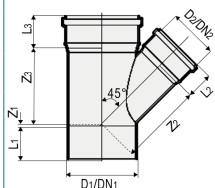
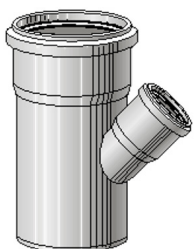

Kód	D ₁ /D ₂	DN ₁ /DN ₂	Z ₁	L ₁	Z ₂	L ₂	Z ₃	L ₃	kg/ks
VS0650551	40/32	40/30	5	52	45	47	42	52	0.050
VS0650557	50/40	50/40	5	50	56	44	54	46	0.090
VS0650563	75/40	70/40	-7	46	79	44	71	52	0.170
VS0650569	75/50	70/50	-1	54	84	46	76	54	0.185
VS0650575	90/40	90/40	-10	56	87	44	76	56	0.225
VS0650581	90/50	90/50	-9	56	90	46	83	56	0.235
VS0650587	110/40	100/40	-24	61	99	44	89	59	0.330
VS0650593	110/50	100/50	-17	61	106	46	79	59	0.355
VS0650599	110/75	100/70	1	61	121	52	112	59	0.460
VS0650689	110/90	100/90	25	61	162	60	135	59	0.755
VS0650605	125/50	125/50	-24	66	114	46	111	65	0.510
VS0650611	125/110	125/100	18	66	146	59	142	65	0.730
VS0650617	160/110	150/100	6	75	185	59	171	73	1.315
VS0650623	160/125	150/125	12	75	184	65	174	73	1.380
VS0650629 *	200/110	200/100	-15	145	228	63	207	135	3.500
VS0650633 *	200/125	200/125	-7	145	237	74	220	135	3.750
VS0650637 *	200/160	200/160	19	145	255	77	245	135	4.300
VS0650643 *	250/110	250/100	37	170	263	63	237	160	5.700
VS0650647 *	250/160	250/150	-2	170	291	77	271	160	6.650
VS0650650 *	250/200	250/200	26	170	309	133	300	160	8.370

* Svařovaný kus

HTEA T-kus 87°30' - redukovaný

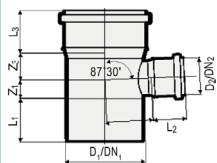
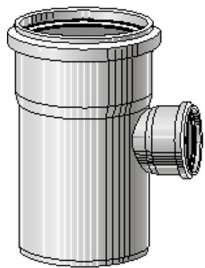

Kód	D ₁ /D ₂	DN ₁ /DN ₂	Z ₁	L ₁	Z ₂	L ₂	Z ₃	L ₃	kg/ks
VS0650555	40/32	40/30	18	52	23	50	20	50	0.048
VS0650561	50/40	50/40	23	50	29	44	24	46	0.080
VS0650567	75/40	70/40	22	53	47	44	30	52	0.160
VS0650573	75/50	70/50	27	53	46	46	35	52	0.170
VS0650579	90/40	90/40	23	56	50	44	29	56	0.205
VS0650585	90/50	90/50	24	56	50	46	34	56	0.220
VS0650591	110/40	100/40	21	61	62	44	32	59	0.310
VS0650597	110/50	100/50	26	61	64	46	37	59	0.330
VS0650603	110/75	100/70	38	61	67	52	49	59	0.395
VS0650691	110/90	100/90	56	61	90	60	65	59	0.610
VS0650609	125/50	125/50	28	66	68	46	36	65	0.405
VS0650615	125/110	125/100	58	66	72	59	64	65	0.600
VS0650621	160/110	150/100	55	75	93	59	71	73	0.960
VS0650627	160/125	150/125	64	75	93	65	79	73	1.155
VS0650631 *	200/110	200/100	55	145	135	63	100	135	3.170
VS0650635 *	200/125	200/125	62	145	133	74	100	135	3.340
VS0650639 *	200/160	200/150	79	145	138	77	116	135	3.600
VS0650645 *	250/110	250/100	59	170	160	63	96	160	5.230
VS0650649 *	250/160	250/150	84	170	175	77	120	160	5.900
VS0650651 *	250/200	250/200	124	170	160	135	140	160	7.160

* Svařovaný kus

Odbočky

HTDA dvojitá odbočka 45°

Kód	D ₁ /D ₂ /D ₃	DN ₁ /DN ₂ /DN ₃	L	Z ₁	L ₁	Z ₂	L ₂	Z ₃	L ₃	Z ₄	L ₄	kg/ks
VS0650655	110/110/110	100/100/100	280	25	61	136	59	136	59	136	59	0.765

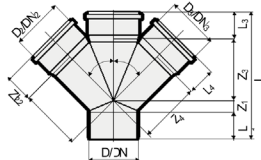

HTDA dvojitá odbočka 87°30'

Kód	D ₁ /D ₂ /D ₃	DN ₁ /DN ₂ /DN ₃	L	Z ₁	L ₁	Z ₂	L ₂	Z ₃	L ₃	Z ₄	L ₄	kg/ks
VS0650654	110/50/50	100/50/50	181.5	25	60	63	44	42.5	54	63	44	0.364
VS0650656	110/110/110	100/100/100	249	64	60	72	52	73	52	72	52	0.978
VS0650659 *	125/110/110	125/100/100	252	59	65	79	52	72	56	79	52	0.896
VS0650667 *	160/110/110	150/100/100	289	61	84	100	52	81	63	100	52	1.315

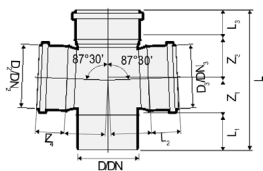
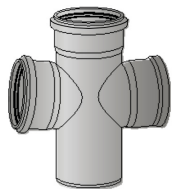

* Svařovaný kus

HTDA Dvojitá odbočka 87°30' - s náběhem

Kód	D ₁ /D ₂ /D ₃	DN ₁ /DN ₂ /DN ₃	Z ₁	L ₁	Z ₂	L ₂	Z ₃	L ₃	L ₄	kg/ks
VS0652911	90/90/90	90/90/90	57	56	64	56	47	56	56	0.531
VS0652912	110/110/75	100/100/70	69	64	78	66	58	59	52	0.649
VS0652913	110/110/90	100/100/90	69	64	78	66	58	59	56	0.684
VS0652914	110/110/110	100/100/100	69	64	78	66	58	59	59	0.722

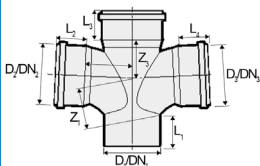
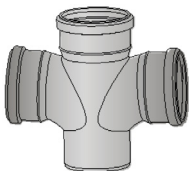

HTED rohová odbočka 87°30'

Kód	D ₁ /D ₂ /D ₃	DN ₁ /DN ₂ /DN ₃	Z ₁	Z ₂	Z ₃	Z ₄	L	L ₁	L ₂	L ₃	L ₄	kg/ks
VS0650657	110/110/110	100/100/100	54	77	71	77	242	63	54	54	54	0.657
VS0650661	125/110/110	125/100/100	54	77	71	77	255	71	54	59	54	0.837
VS0650662 *	160/110/110	150/100/100	68	100	77	100	290	78	52	67	52	1.357

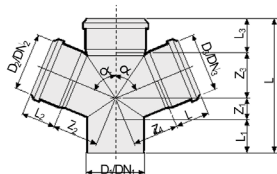
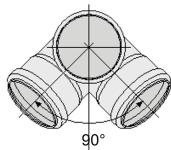

* Svařovaný kus

Triplus multibranch

Kód	D	D ₁	D ₂	L	L ₁	L ₂	kg/ks
VS0652001	110	110	4x32-50	230	55	250	0.809

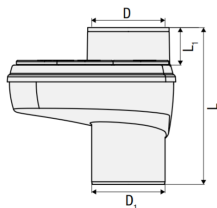
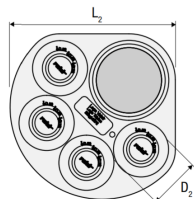
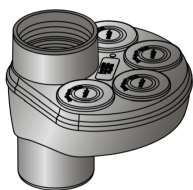

Směšovací tvarovka VBF

Kód	D	DN	D ₁ /D ₂ /D ₃	D ₄ /D ₅ /D ₆	L	L ₁	L ₂	L ₃	L ₄	H	H ₁	H ₂	H ₃
VS0651X ₁ X ₂ X ₃ X ₄ X ₅ X ₆ *	110	100	110	75	340	160	130	50	300	760	230	170	360

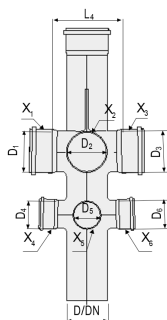
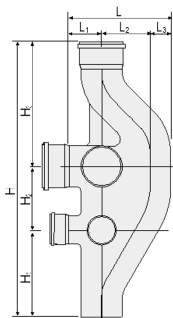
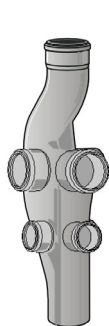

* X=0, pokud vstup nemá objímku; X=1, pokud je objímka přivařena ke vstupu

Vpust, vertikální a horizontální spojení

Kód	D	D _{in}	D _{out}	L ₁	L ₂	L ₃	kg/ks
VS0701741	110	3x50	1x75	220	230	200	0.590

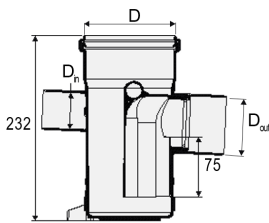
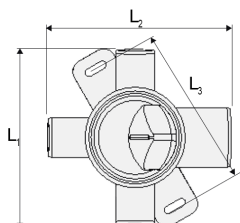
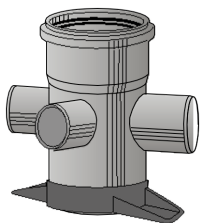

HTRE Čistící kus

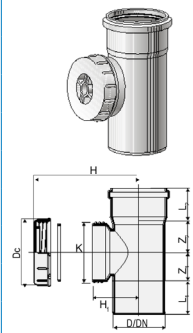

Kód	D/DN	Z ₁	L ₁	Z ₂	L ₂	H	Dc	K	H ₁	kg/ks
VS0650901	50/50	36	48	35	46	60	90	74	57	0.150
VS0650903	75/70	40	53	43	52	80	90	74	66	0.240
VS0650905	90/90	49	58	55	56	8	120	105	80	0.365
VS0650907	110/100	55	61	65	59	100	120	105	90	0.520
VS0650909	125/125	65	66	71	65	105	150	128	98	0.750
VS0650911	160/150	64	75	75	73	105	150	128	118	1.300
VS0650913*	200/200	76	145	110	135	150	150	128	142	3.283
VS0650915 *	250/250	81	170	113	160	165	150	128	158	5.440

* Svařovaný kus

HTM Zátka do hrdla

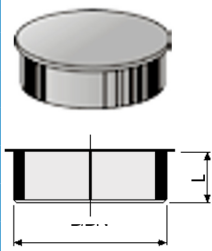

Kód	D/DN	L	kg/ks
VS0650951	40/40	32	0.015
VS0650953	50/50	32	0.020
VS0650955	75/70	32	0.035
VS0650957	90/90	42	0.070
VS0650959	110/100	42	0.100
VS0650961	125/125	51	0.150
VS0650963	160/150	57	0.270

HTS Přímý konektor se zátkou bez manžety

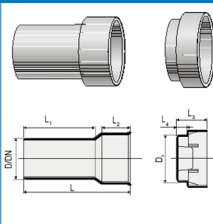

Kód	D/D ₁	DN	L ₁	L ₂	L ₃	L ₄	L	kg/ks
VS0650981	32/46	30	54	26	30	10	88	0.040
VS0650982	40/46	40	54	26	30	10	88	0.045
VS0650983	40/50	40	54	28	35	10	88	0.050
VS0650984	40/53.5	40	38	24	30	10	70	0.050
VS0650985	50/53.5	50	54	26	30	10	88	0.055

HTSW Sifonové koleno krátké bez manžety

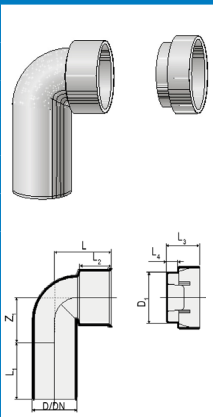

Kód	D/D ₁	DN	Z ₁	L ₁	L ₂	L ₃	L ₄	L	kg/ks
VS0650971	32/46	30	23	51	27	30	10	50	0.050
VS0650972	40/46	40	23	51	30	30	10	50	0.056
VS0650973	40/53.5	40	28	52	27	30	10	52	0.060
VS0650974	50/53.5	50	28	52	28	30	10	52	0.065
VS0650975	50/60	50	28	52	28	30	10	52	0.060

HTSW Sifonové koleno dlouhé bez manžety

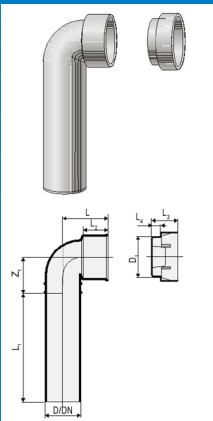

Kód	D/D ₁	DN	Z ₁	L ₁	L ₂	L ₃	L ₄	L	kg/ks
VS0650991	32/46	30	36	124	28	30	10	50	0.065
VS0650992	40/46	40	36	124	28	30	10	50	0.070
VS0650993	40/50	40	36	119	32	35	10	50	0.070
VS0650996	32/50	30	36	119	28	35	10	53	0.075

Manžeta HTGM

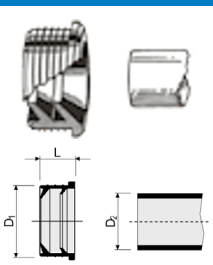

Kód	D ₁	D ₂	L	kg/ks
4163001b	46	24-32	22	0.020
4163002	46	36-40	22	0.010
VS0523011	50	36-40	22	0.020
VS0523015	53.5	24-32	22	0.030
4163004	53.5	36-40	22	0.025
4163006	60	46-55	24	0.020

Užití manžet

HTS Přímý konektor se zátkou

Kód	HTGM Manžeta	HTGM Manžeta
VS0650981	4163001b	4163002
VS0650982	4163001b	4163002
VS0650983	VS0523011	VS0523015
VS0650984	VS0523015	4163004
VS0650985	VS0523015	4163004

HTSW Sifonové koleno krátké

Kód	HTGM Manžeta	HTGM Manžeta
VS0650971	4163001b	4163002
VS0650972	4163001b	4163002
VS0650973	VS0523015	4163004
VS0650974	VS0523015	4163004
VS0650975	4163006	

HTSW Sifonové koleno dlouhé

Kód	HTGM Manžeta	HTGM Manžeta
VS0650991	4163001b	4163002
VS0650992	4163001b	4163002
VS0650993	VS0523011	
VS0650996	VS0523011	

Redukce

HTRK Redukce krátká

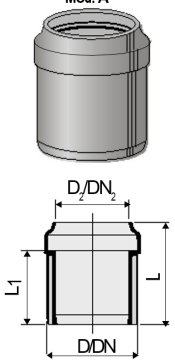
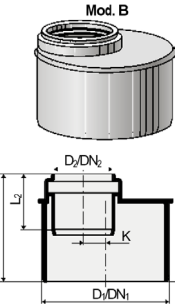
Mod. A		Model A - symetrická								
	Kód	D ₁ /D ₂	DN ₁ /DN ₂	L	L ₁	kg/ks				
	VS0650790	40/32	40/30	65	50	0.025				
	VS0650791	50/40	50/40	56	38	0.025				
	VS0650793	90/75	90/75	76	61	0.064				
	VS0650795	110/90	100/90	81.5	65	0.110				
VS0650797	125/110	125/100	86	68	0.175					
Mod. B		Model B - excentrická								
	Kód	D ₁ /D ₂	DN ₁ /DN ₂	Mod.	K	Z ₁	L ₁	L ₂	L	kg/ks
	VS0650707	75/40	70/40	B	9	-	56	39	74	0.065
	VS0650709	75/50	70/50	B	4	-	56	42	73	0.075
	VS0650711	90/40	90/40	B	16	-	59	40	77	0.095
	VS0650713	90/50	90/50	B	11	-	61	42	78	0.100
	VS0650717	110/40	100/40	B	25	-	63	40	79	0.150
	VS0650719	110/50	100/50	B	20	-	63	42	80	0.150
	VS0650721	110/75	100/70	B	7	-	63	47	80	0.160
	VS0650731	160/110	150/100	B	10	-	85	52	103	0.480
	VS0650733	160/125	150/125	B	4	-	86	56	105	0.345
	VS0650735 *	200/110	200/100	B	10	45	90	55	191	1.925

* Svařovaný kus

HTR Redukce dlouhá - excentrická

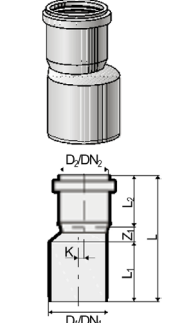
Mod. A		Model A - symetrická								
	Kód	D ₁ /D ₂	DN ₁ /DN ₂	Mod.	K	Z ₁	L ₁	L ₂	L	kg/ks
	VS0650701	40/32	40/30	A	0	11	44	45	100	0.023
	VS0650703	50/32	50/30	A	0	14	47	44	105	0.028
	VS0650705	50/40	50/40	A	5	12	51	44	107	0.045
	VS0650715	90/75	90/70	A	5	3	57	47	107	0.120
	VS0650723	110/90	100/90	A	7	3	60	50	113	0.170
	VS0650729	125/110	125/100	A	4	6	67	49	122	0.240
	VS0650739 *	200/160	200/150	A	18	45	93	77	215	1.905
	VS0650747 *	250/200	250/200	A	23	51	124	135	310	3.730

* Svařovaný kus

HTU Spojka přesuvná

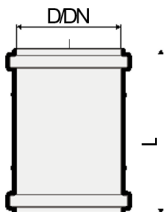

Kód	D/DN	L	kg/ks
VS0650801	32/30	86	0.023
VS0650803	40/40	100	0.040
VS0650805	50/50	105	0.050
VS0650807	75/70	120	0.120
VS0650809	90/90	120	0.150
VS0650811	110/100	136	0.255
VS0650813	125/125	147	0.370
VS0650815	160/150	180	0.635
VS0650817 *	200/200	195	1.070
VS0650819 *	250/250	243	2.110

Spojka dvouhrdlá (nátrubek)

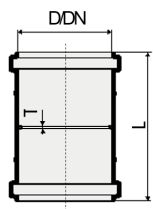
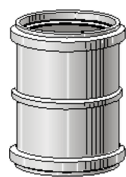

Kód	D/DN	L	T	kg/ks
VS0650851	32/32	85	2	0.023
VS0650853	40/40	100	2	0.040
VS0650855	50/50	105	2	0.050
VS0650857	75/70	120	2	0.120
VS0650859	90/90	120	3	0.155
VS0650861	110/100	136	3	0.260
VS0650863	125/125	147	3	0.380
VS0650865	160/150	180	3	0.645
VS0650867 *	200/200	373	14	2.030
VS0650869 *	250/250	466	20	4.460

HTL Prodloužené hrdlo

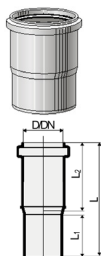

Kód	D/DN	L ₁	L ₂	L	kg/ks
VS0650751	40/40	47	75	126	0.040
VS0650753	50/50	48	79	131	0.055
VS0650755	75/70	53	90	150	0.100
VS0650757	90/90	56	95	159	0.150
VS0650759	110/100	61	100	169	0.230
VS0650761	125/125	66	108	182	0.350

HTL Prodloužené hrdlo - delší

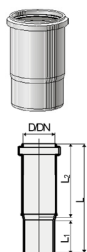

Kód	D/DN	L ₁	L ₂	L	kg/ks
VS0650771	40/40	47	100	152	0.060
VS0650773	50/50	48	107	160	0.080
VS0650775	75/70	53	124	183	0.120
VS0650777	90/90	56	129	193	0.190
VS0650779	110/100	61	136	205	0.280
VS0650781	125/125	66	145	220	0.400

Ochranná krytka do hrdla

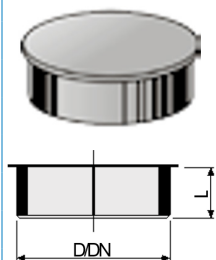

Kód	D	DN	L	kg/ks
VS0503000	32	30	16	0.005
VS0503001	40	40	36	0.005
VS0503003	50	50	36	0.010
VS0503005	75	70	36	0.020
VS0503008	90	90	36	0.030
VS0503007	110	100	36	0.040
VS0503009	125	125	36	0.050
VS0503011	160	150	36	0.055
VS0503013	200	210	38	0.065

PVC adaptér

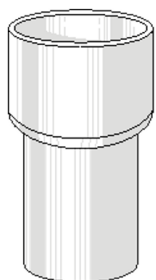

Kód	Mod.	D (PVC)	D	H	kg/ks
VS0531323	A	43	40	80	0.040
VS0531325	A	56	50	88.5	0.062
VS0531326	B	60	50	90	0.064
VS0531327	C	70	75	53	0.094
VS0531333	A	125	110	300	0.460
VS0531335	A	140	110	420	0.650
VS0531337	A	150	125	420	0.750

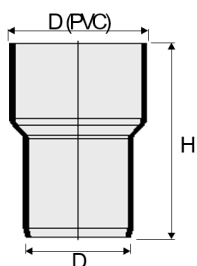

Mod. A

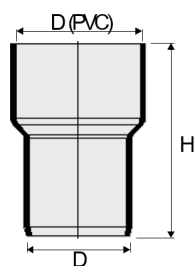

Mod. B

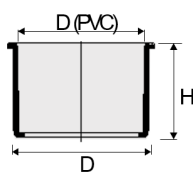

Mod. C

Vazelína pro hrdlové spoje



Kód	typ balení	kg/ks	balení
0017150	tuba	0,15	50
0017250	tuba	0,25	50
0017500	tuba	0,50	24
0016900	kbelík	1,00	12

HTKLAP zpětná klapka s aretací KARMAT

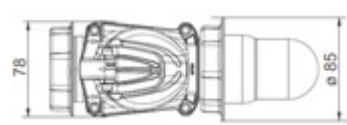
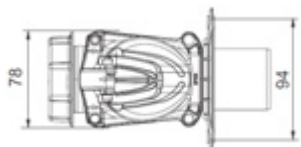
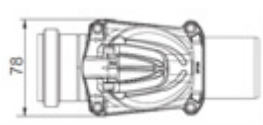
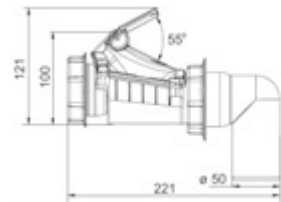
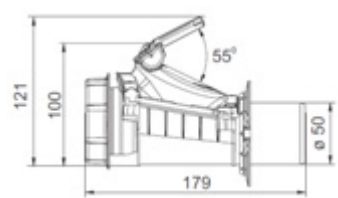
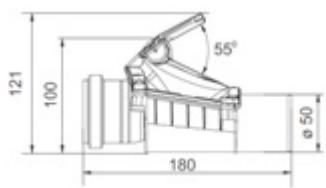

Kód	d _c	DN	Š	v	verze	barva	kg/ks	balení
K4619000	50	50	78	100	A	šedá	0,15	1
K4619001	50	50	78	100	B	šedá	0,17	1
K4619002	50	50	78	100	C	šedá	0,22	1
K4619003	50	50	78	100	C	bílá	0,22	1



AUTHORIZED BODY No. 224
Institute for Testing and Certification, Inc., T. Bati 299, Louky, 763 02 Zlín,
Czech Republic
Authorization granted by the Decision No. 2/2014 dated 10th March 2014

PRODUCT CERTIFICATE

No. 14 0219 V/AO

In compliance with the provision of Section 5a, Subsection 2 of the Government Order No. 163/2002, Collection of Laws, as amended by the Government Order No. 312/2005, Collection of Laws, which lays down technical requirements for selected building products, the Authorized Body No. 224 confirms that for the construction product

PP pipes and fittings for sewerage systems (for low and high temperature) inside buildings, DN/OD 32 – DN/OD 160, “B” application area code, TRIPLUS[®] system

placed on the market by the manufacturer

VALSIR S. p. A.
Località Merlaro, 2, 25078 Vestone (BS), Italy
VAT No: IT00700170988

from production site

VALSIR S. p. A.
Località Merlaro, 2, 25078 Vestone (BS), Italy

it has reviewed the documents submitted by the applicant, carried out the initial type testing on a sample and assessed the factory production control. The Authorized Body No. 224 ascertained conformity of the product properties with essential requirements of the Government Order No. 163/2002, Collection of Laws, as amended by the Government Order No. 312/2005, Collection of Laws, which are specified by the ČSN EN 1451-1.

Further, the Authorized Body No. 224 ascertained that the factory production control complies with the submitted technical documentation and ensures that the products placed on the market fulfil the requirements laid down by the above mentioned Standard and by the technical documentation pursuant to Section 4, Subsection 3 of the Government Order No. 163/2002, as amended.

A part of the present Certificate is the Final Report No. **793501291/2014** dated 23rd April 2014 containing conclusions of the assessment, the test results obtained and basic description of the product, as necessary for its identification. *This Certificate remains valid as long as the requirements laid down in the technical documentation and/or Construction Technical Approval in reference or the manufacturing conditions in the factory or the method of checks on the products are not modified significantly.*

The Authorized Body No. 224 performs at least once per year a surveillance of the factory production control in the production site with the requirements of the norms according to the Section 5a, of the mentioned Government Order. If the Authorized Body finds any shortcomings it has the right to cancel or amend the Certificate it has issued.

Issued in Zlín, on 23rd April 2014



Paul Voj
RNDr. Radomír Čevelík
Representative of the Authorized Body No. 224



Media-tic - Barcelona (Spain)



Viceroy Hotel Yas Island F1 Circuit (Abu Dhabi, United Arab Emirates)



Nation Towers - Abu Dhabi (United Arab Emirates)

Reference



Life Republic - Pune (India)



RBA - Barcelona (Spain)



Torres Intempo - Benidorm (Spain)



Al Raha Beach Development - Abu Dhabi (United Arab Emirates)



Mikrohaus Loft - Wien (Austria)

